

- GENERAL NOTES**
- TOTAL SITE AREA = 1,223,205 SF (28.08 AC)  
TOTAL PROPOSED LANDSCAPE AREA = 367,206 SF (8.43 AC)  
PERCENT OF LANDSCAPE AREA ON-SITE = 30.00%
  - TOTAL LANDSCAPE AREA IN R.O.W. = 130,074 SF (2.99 AC)
  - PROPOSED TRACK ELEVATIONS ON RAILROAD ARE PRELIMINARY AND SUBJECT TO RAILROAD APPROVAL.

- DESIGN CRITERIA**
- ON-SITE STORMWATER RETENTION FOR TOTAL OF FIVE (5) INCH RAINFALL:  
MIN. TWO (2) INCHES OF STORAGE IN DRENNELLS.  
MAX. THREE (3) INCHES OF POND STORAGE.
  - ON-SITE LIGHTING:  
MAX. LUMINAIRE OPTICAL HEIGHT IN YARD IS 50'.  
MAX. LUMINAIRE OPTICAL HEIGHT ALONG ACCESS ROAD IS 20' (BROOKHAVEN STANDARDS).  
ALL LIGHT LUMINAIRES WILL BE "DARK SKY" FRIENDLY.
  - ON-SITE SANITARY DISPOSAL SYSTEM TO COMPLY WITH SUFFOLK COUNTY SANITARY CODE.
  - DUST CONTROL-PUBLIC WATER TO AGGREGATE STORAGE AREA.
  - 50' MAX. BUILDING HEIGHT.
  - 50' MAX. STOCKPILE HEIGHT.
  - PROPOSED NEW PLANTING ALONG SILLS ROAD SHALL BE MINIMUM 8" TO 10" HIGH EVERGREENS, STAGGERED PLANTINGS 12' O.C.
  - IN CASE WHERE PROPOSED SLOPE IS GREATER THAN 33 1/3%, ADEQUATE STABILIZATION OF THE SLOPE WILL BE PROVIDED.
  - A STORMWATER POLLUTION PREVENTION PLAN OR A REQUEST FOR WAIVER WILL BE SUBMITTED TO THE TOWN.

**LEGEND**

- - - - - SUBJECT PROPERTY LINE
- - - - - LOT LINE
- - - - - EASEMENT LINE
- - - - - EXISTING ELEVATION
- - - - - PROPOSED ELEVATION
- - - - - PROPOSED TOP OF SLOPE ELEVATION
- - - - - PROPOSED TOP OF WALL ELEVATION
- - - - - PROPOSED BOTTOM OF WALL ELEVATION
- - - - - TRUCK FLOW ARROW
- - - - - PROPOSED GUIDERAIL
- - - - - PROPOSED 6" HIGH CHAIN LINK SECURITY FENCE
- - - - - EX. CHAIN LINK FENCE
- - - - - PROPOSED RAILROAD TRACKS
- - - - - EXISTING RAILROAD TRACKS
- - - - - PROPOSED VEGETATION

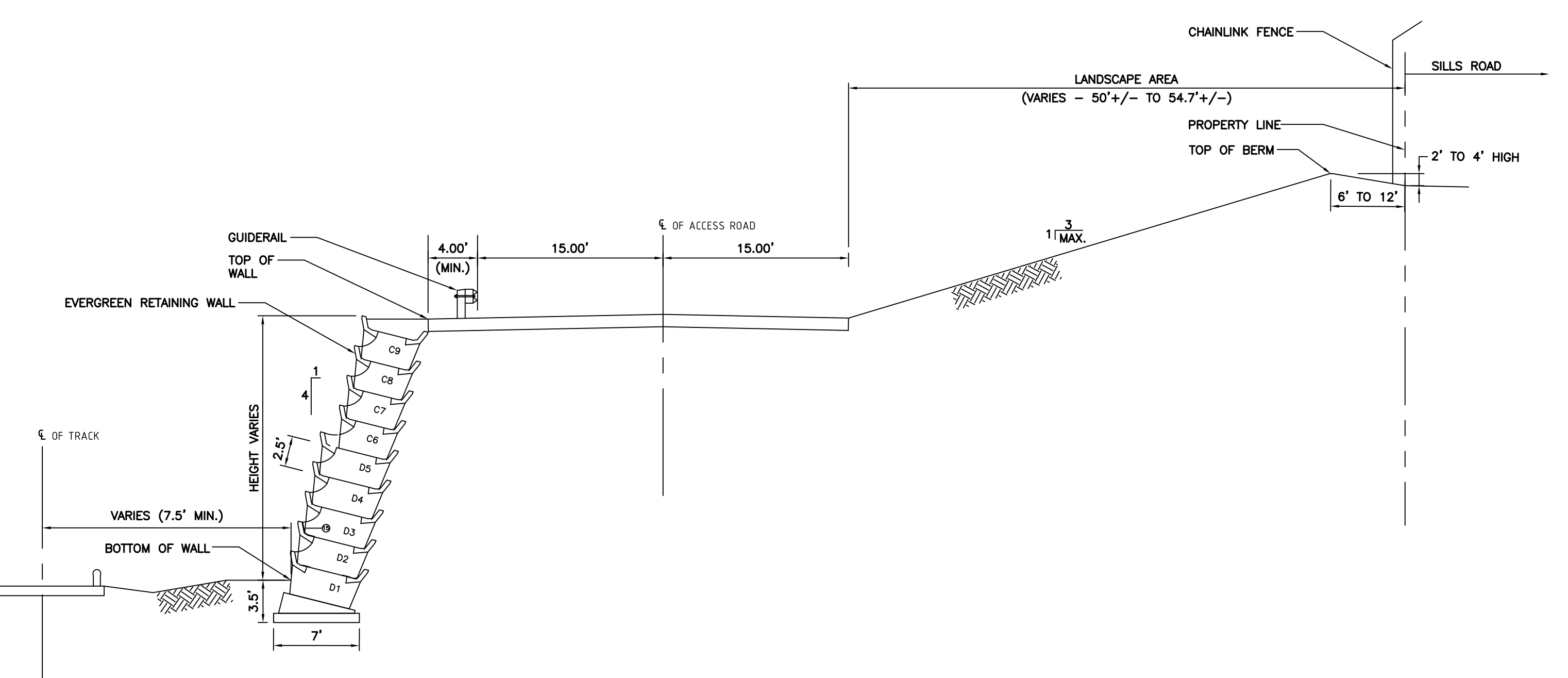

**SECTION A-A TYPICAL ACCESS ROAD**  
NOT TO SCALE

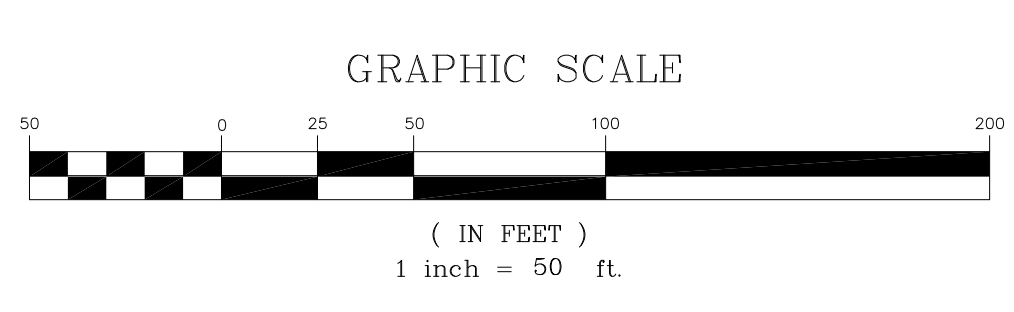
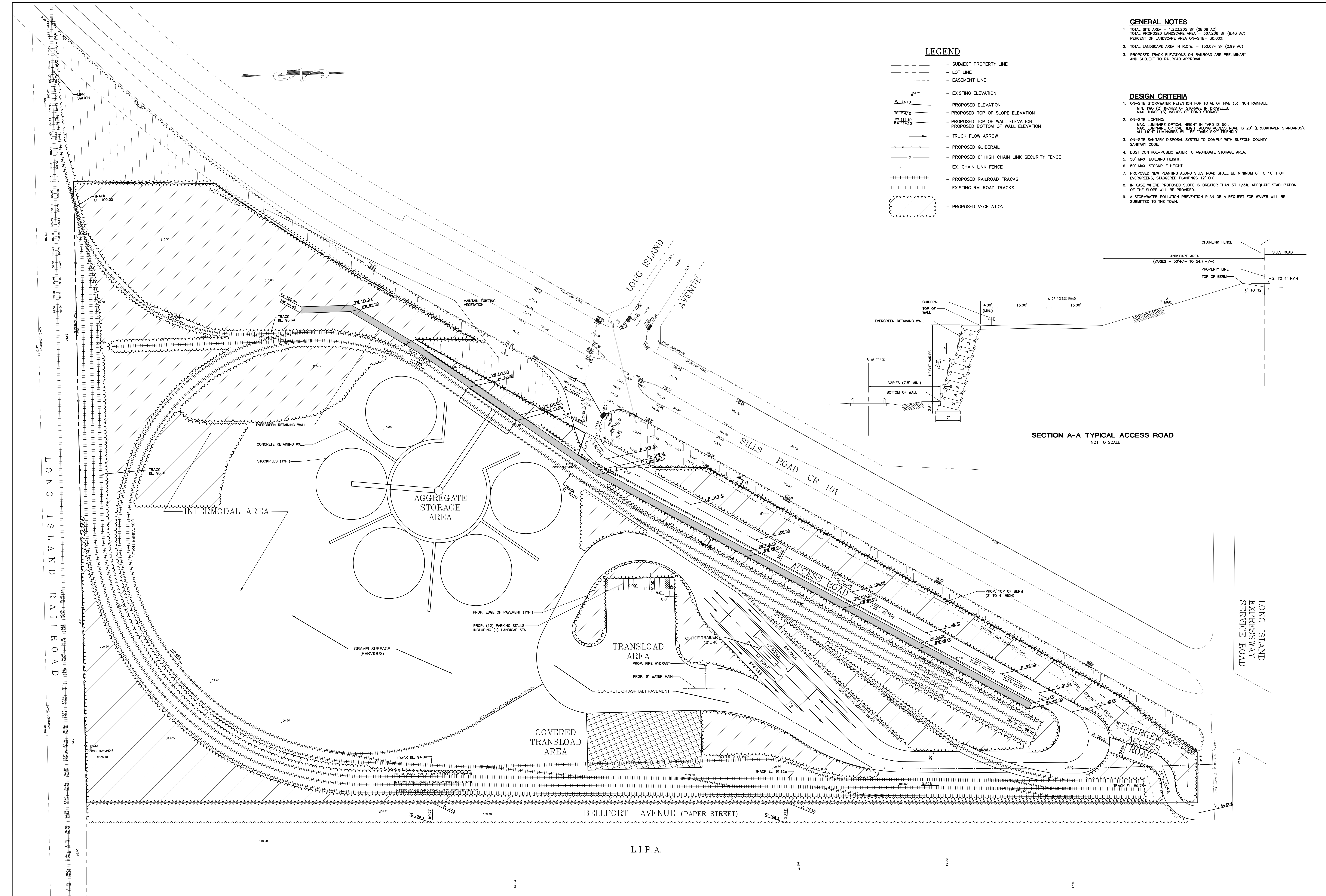

NOTE:  
ALL EXISTING ELEVATIONS ARE INTERPOLATED FROM A CONTOUR MAP BY OTHERS. ACTUAL ELEVATIONS MAY NEED TO BE VERIFIED IN THE FIELD.

NOTE:  
Under N.Y. Education Law Sec. 7209 Sub. 2, it is illegal for any person, unless acting under the direction of a LICENSED Professional Engineer, to alter any item on this contract in any way. If any item has been altered, the contractor shall be liable to the client for any and all damages. The contractor shall also be liable for any and all damages caused by the alteration. The contractor shall be held responsible for the accuracy of the information provided on this plan. The contractor shall be held responsible for the accuracy of the information provided on this plan.

**SITE LAYOUT PLAN**  
BROOKHAVEN RAIL TERMINAL  
YAPHANK, NEW YORK

NO.	DATE	REVISION	BY
6	6/15/09	REVISE PER TOWN COMMENTS DATED 6/8/09	LK
5	6/03/09	ADD ELEVATIONS AT POLES PER LPA COMMENT	LK
4	5/15/09	SHOW EXIST. UIP LOCATIONS & ADD EASEMENTS	LK
3	4/23/09	REVISE STOCKPILE AREA & ADD WALL AT ACCESS ROAD	LK
2	4/10/09	ADD ACCESS ROAD PER CLIENT	WNT
1	12/4/08	AS PER CLIENT COMMENTS	WNT

**BOWNE AEST GROUP**  
Where Experience Empowers Vision

**Sidney B. Bowne & Son, LLP**  
235 East Jericho Turnpike  
Mineola, NY 11501  
Phone: 516-745-2350  
Fax: 516-747-1396  
www.bownegroup.com

SCALE: PLAN: 1"=50'  
PROFILE: HORIZ: N/A  
VERT: N/A  
DATE: AUGUST 2007

DESIGNED BY: RM  
DRAFTED BY: HKR  
CHECKED BY: JC  
PROJECT NO: 10783059  
SHEET NUMBER: CP-1 OF 1